

**△ SPECIFICATION**

Current Rating: 3A AC/DC  
 Voltage Rating: 250V AC/DC  
 Temperature Range: -25°C~+85°C  
 Contact Resistance: 10 Milliohms Max.  
 Insulation Resistance: 1000 Megaohms Min.  
 Withstanding Voltage: 1000V AC/Minute  
 Insulator: PA66(UL94V-0), White  
 RoHS Compliant

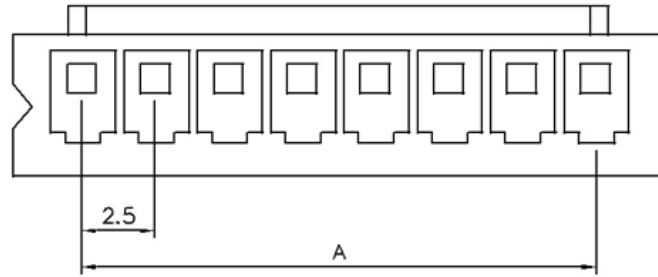

△

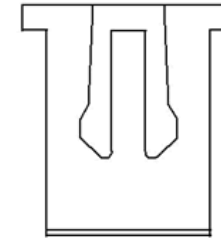
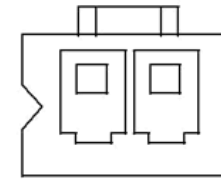

△ 2 Pin

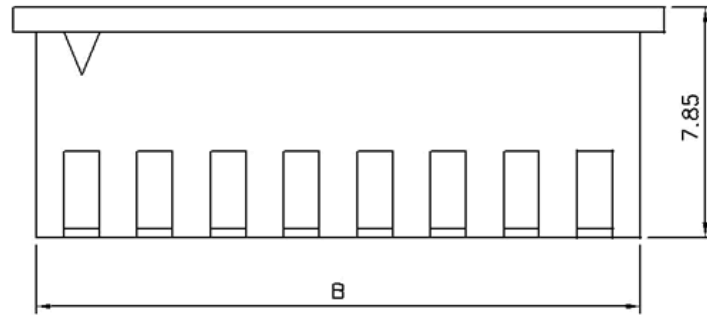

△

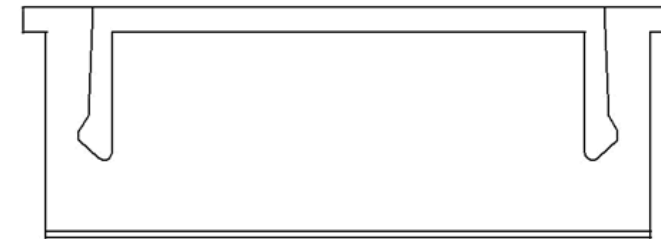
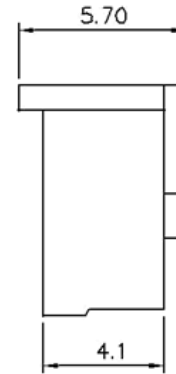

△ 3~20 Pin

Pin	A	B
2	2.50	5.70
3	5.00	8.20
4	7.50	10.70
5	10.00	13.20
6	12.50	15.70
7	15.00	18.20
8	17.50	20.70
9	20.00	23.20
10	22.50	25.70
11	25.00	28.20
12	27.50	30.70
13	30.00	33.20
14	32.50	35.70
15	35.00	38.20
16	37.50	40.70
20	47.50	50.70



باتو الکترونیک

**BATOETC.COM**

DRAWING No.

APPROVED BY

MEI

CHECKED BY

HZF

DRAWING BY

QQJ

UNLESS OTHERWISE SPECIFIED

TOLERANCES ARE

.X ±0.30 △

.XX ±0.20

SCALE

NONE

REV.

A2

UNIT

mm



NO.

REV.

REVISIONS

CHK

DATE

△ A2 Modify Data HZF 03/24/2010

△ A1 Modify Data BECKY 2004/11/19

△ A0 NEW RELEASE